

GENERAL LIGHTING INSTALLATION NOTE:

LIGHTING POSITIONS SHOWN ON DRAWING ARE NOT INDICATIVE OF THE FINAL POSITIONS OF LIGHTS ON SITE. FINAL POSITIONS OF LIGHTS ON SITE ARE TO BE CONFIRMED AND TESTED AND REPLACED WHERE NECESSARY. EXISTING LIGHT POSITIONS ARE NOT TO BE MOVED/RELOCATED UNLESS OTHERWISE NOTED BY THE ELECTRICAL ENGINEER.

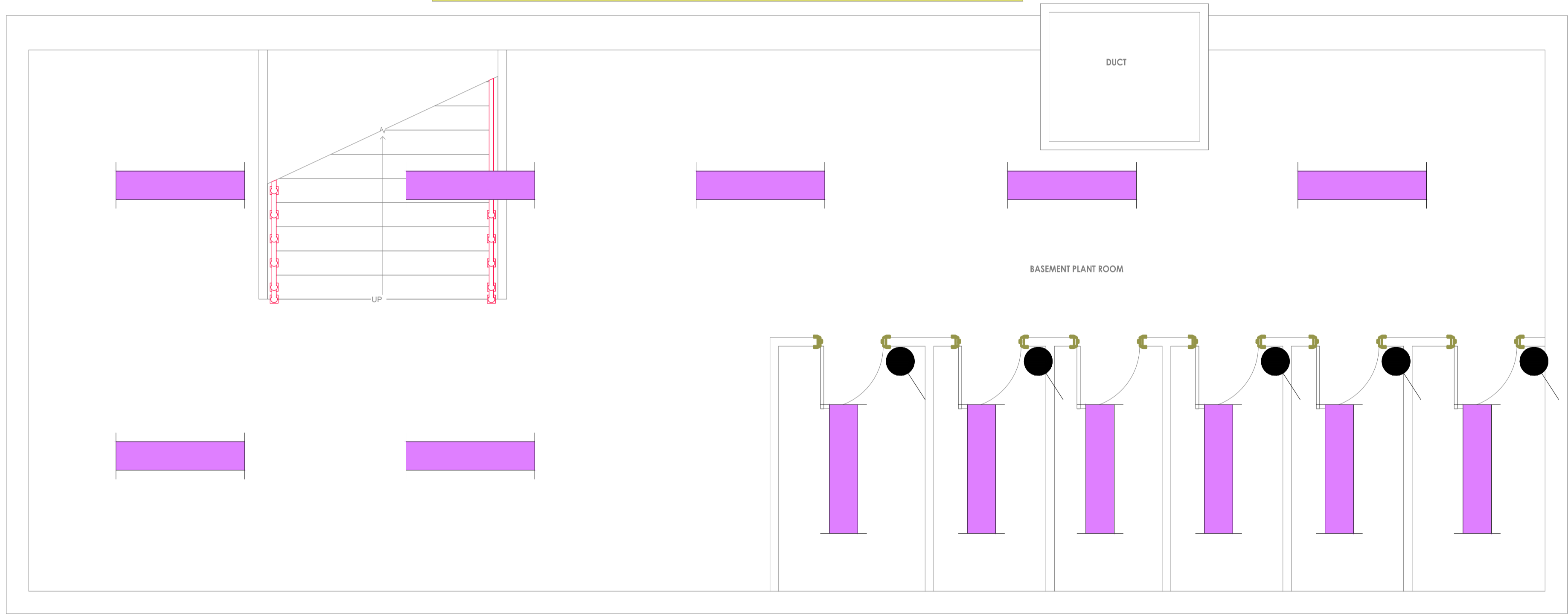

LIGHTING LEGEND	
	SURFACE CHANNEL FLUORESCENT C/W 2x58W LAMP
	SURFACE CHANNEL FLUORESCENT C/W 1x58W LAMP
	WL WALL MOUNTED BULKHEAD LIGHT C/W 1x18W PL LAMP
	D 1200x600 LOW BRIGHTNESS FLUORESCENT C/W 3x36W LAMPS
	G RECESSED DOWNLIGHTER C/W 13W PL LAMP
	GE RECESSED DOWNLIGHTER C/W 13W PL LAMP WITH EMERGENCY BACKUP
	S 1200x600 RECESSED PRISMATIC LUMINAIRE C/W 3x36W LAMPS
	T 600x600 LOW BRIGHTNESS FLUORESCENT C/W 3x18W LAMPS
	● DOME LIGHT
	● DOMESTIC BALL LIGHT
	● BALL LIGHT
	▴ ELECTRICAL DISTRIBUTION BOARD
	● SINGLE POLE LIGHT SWITCH, 1 LEVER
	● SINGLE POLE LIGHT SWITCH, 2 LEVER

- General Installation Notes:**
- All conduits shall be SANS/SABS approved PVC with galvanised saddles where not recessed.
 - All recessed conduits shall be SANS/SABS approved PVC with galvanised outlet boxes (Except 65mm round boxes)
 - Heights AFFL (above finished floor level) shown to the bottom of outlets/equipment
 - All outlets, wiring and conduits to be installed by electrical contractor.
 - All equipment to be supplied as specified. No alternatives shall be accepted/considered.
 - This drawing to be read in conjunction with all other related drawings as well as the specifications for coordination purposes
 - Do not scale lengths of sleeves, cables etc from drawings. Measure on site.
 - A complete set of drawings must be always available on site.
 - For conductor sizing, refer to Single Line Diagrams.
 - Non-corroding draw wire to be installed in all spare sleeves and conduits.
 - Discrepancies, errors, and omissions are to be brought to the Engineer's attention immediately they become evident.
- General Lighting Installation Notes**
- All light switches mounted at 1200mm AFFL unless otherwise specified.
- General Power Installation Notes**
- All socket outlets mounted at 500mm AFFL unless otherwise specified. Electrical contractor to determine worktop heights before installing outlets above worktop spaces.

REV	DATE	REVISION DETAILS
00	13.10.2022	PRELIMINARY DESIGN
01	12.01.2023	DRAWING REVISED AND NOTES ADDED

COPYRIGHT OF THIS DESIGN AND DRAWINGS IS RESERVED. SCALED DIMENSIONS ARE INVALID. ALL DIMENSIONS AND LEVELS TO BE VERIFIED ON SITE PRIOR TO COMMENCEMENT OF WORK. DISCREPANCIES TO BE REPORTED IMMEDIATELY. ALL BUILDING WORK TO BE IN COMPLIANCE WITH NATIONAL BUILDING REGULATIONS, SOUTH AFRICAN NATIONAL STANDARDS AND LOCAL AUTHORITY BY-LAWS.

THE MASTER IS HELD AT ELTEK ENGINEERING SERVICES AND BEARS THE ORIGINAL SIGNATURE OF APPROVAL.

.....

.....

.....

JDA Johannesburg Development Agency

THE BUS FACTORY NO. 3
HELEN JOSEPH STREET
NEWTOWN
JOHANNESBURG
TEL: 011 688 7851

KAGO CONSULTING SERVICES (Kago Built Environment Consultants)

Unit 4, Block Q31 WATERSFORD COURT
Cnr Rieba St & Glover Ave
CENTURION
0157

Tel: (011) 318 0122
Fax: (086) 589 4017

KAGO
CONSULTING SERVICES (PTY) LTD

JOHANNESBURG CENTRAL LIBRARY

BASEMENT PLANT ROOM LEVEL LIGHTING LAYOUT

DATE	02/06/2022	SCALE	N.T.S
DESIGNED	N. MABUZA	DESIGNED	K. LLOYD
PROJ - JCL/LIGHTS 012		01	

ISSUED FOR INFORMATION